

INSTALLATION INSTRUCTIONS

KITCHEN FAUCET (WALL-MOUNTED)

廚房龍頭(壁式)安裝說明

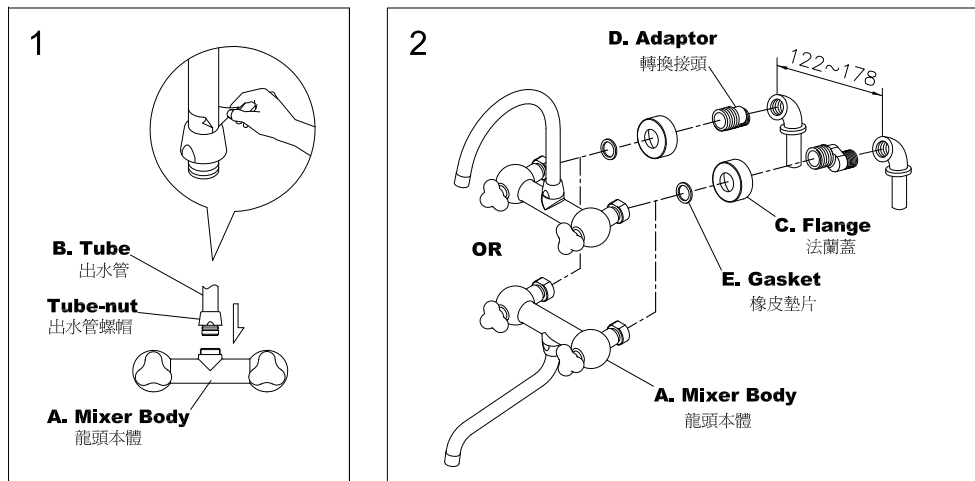

NOTE: The available distance between two centers of wall water-outlet can be 122~178mm as Fig.2 shown.

凡牆壁上冷熱出水孔中心距離在122~178mm者，皆可適合安裝本產品。如 Fig.2 所示。

1. Tear the protect membrane, then Insert **Tube** into **Mixer body** and tighten the **tube-nut** as Fig.1 shown.

撕去保護膜，然後將出水管置入龍頭本體，並且將出水管螺帽鎖緊固定住。如 Fig.1 所示。

2. Apply pipe compound or thread sealant tape to the thread of **Adaptor** 1/2" end, and screw it into wall water-outlet. Cover **Flanges** onto both 3/4" end of **Adaptors**, then insert **Gaskets** into each body-nut and screw the body-nut onto **Adaptors** 3/4" end and tighten fixed as Fig.2 shown.

將轉換接頭1/2"牙塗上管牙膠或包覆止洩帶，再鎖入牆壁出水口，將2法蘭蓋各別裝上轉換接頭的3/4"那邊，然後將墊片各別裝入本體螺帽，並且將本體螺帽鎖在轉換接頭3/4"那端鎖緊固定住。如 Fig.2 所示。

FIXING CONTENTS

組配件內容

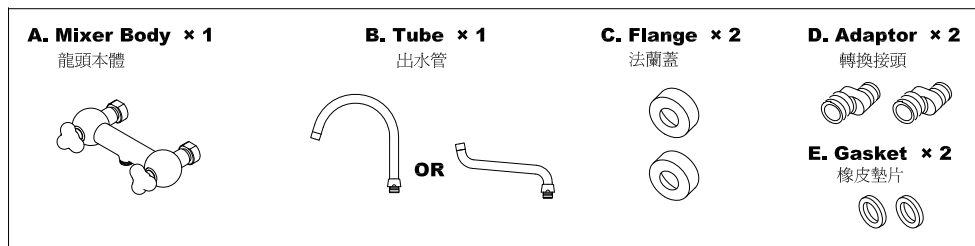

INSTALLATION INSTRUCTIONS

KITCHEN FAUCET (WALL-MOUNTED)

廚房龍頭(壁式)安裝說明

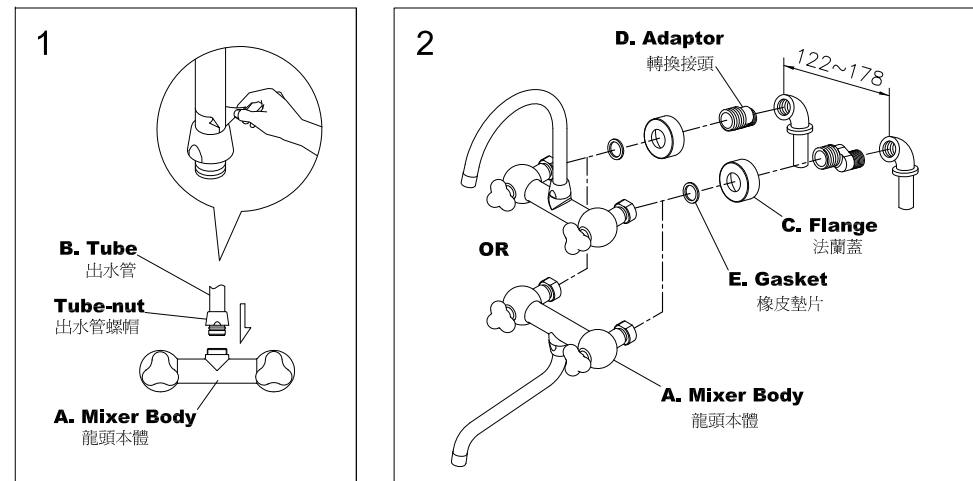

NOTE: The available distance between two centers of wall water-outlet can be 122~178mm as Fig.2 shown.

凡牆壁上冷熱出水孔中心距離在122~178mm者，皆可適合安裝本產品。如 Fig.2 所示。

1. Tear the protect membrane, then Insert **Tube** into **Mixer body** and tighten the **tube-nut** as Fig.1 shown.

撕去保護膜，然後將出水管置入龍頭本體，並且將出水管螺帽鎖緊固定住。如 Fig.1 所示。

2. Apply pipe compound or thread sealant tape to the thread of **Adaptor** 1/2" end, and screw it into wall water-outlet. Cover **Flanges** onto both 3/4" end of **Adaptors**, then insert **Gaskets** into each body-nut and screw the body-nut onto **Adaptors** 3/4" end and tighten fixed as Fig.2 shown.

將轉換接頭1/2"牙塗上管牙膠或包覆止洩帶，再鎖入牆壁出水口，將2法蘭蓋各別裝上轉換接頭的3/4"那邊，然後將墊片各別裝入本體螺帽，並且將本體螺帽鎖在轉換接頭3/4"那端鎖緊固定住。如 Fig.2 所示。

FIXING CONTENTS

組配件內容

